

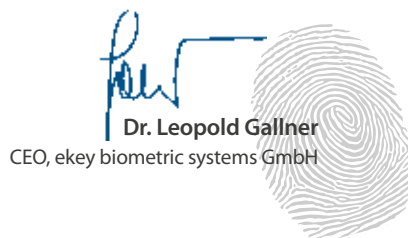

ekey finger scanners
Door set solutions for industry + trade



” *After hundreds of years of service, the key has served its time – now you literally have the future in your hands!* “



Turn your house into a truly smart home with ekey

A fingerprint system combines design, convenience, and security.

Good reasons to choose an *ekey fingerprint scanner*:



UNRIVALED CONVENIENCE

Impossible to lock yourself out, as your finger is always on hand!



MAXIMUM SECURITY

- No lost or stolen keys!
- Maximum protection against forgery thanks to live finger detection with RF sensor technology!
- Impossible for access authorization to be passed on (with a card, code, or key, for example)!
- 1,000 times more secure than a 4-digit code!



USER-FRIENDLY

Easy installation and administration!



INTELLIGENT SOFTWARE

The ekey software is constantly learning – it can detect the growth of children's fingers as well as minor injuries and changes to users' habits.



CONNECTION TO BUILDING CONTROL SYSTEMS

Customized scenarios can be triggered using the ekey fingerprint access control system.



5-YEAR QUALITY GUARANTEE

For all ekey products!

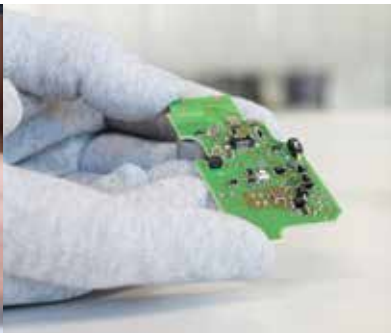
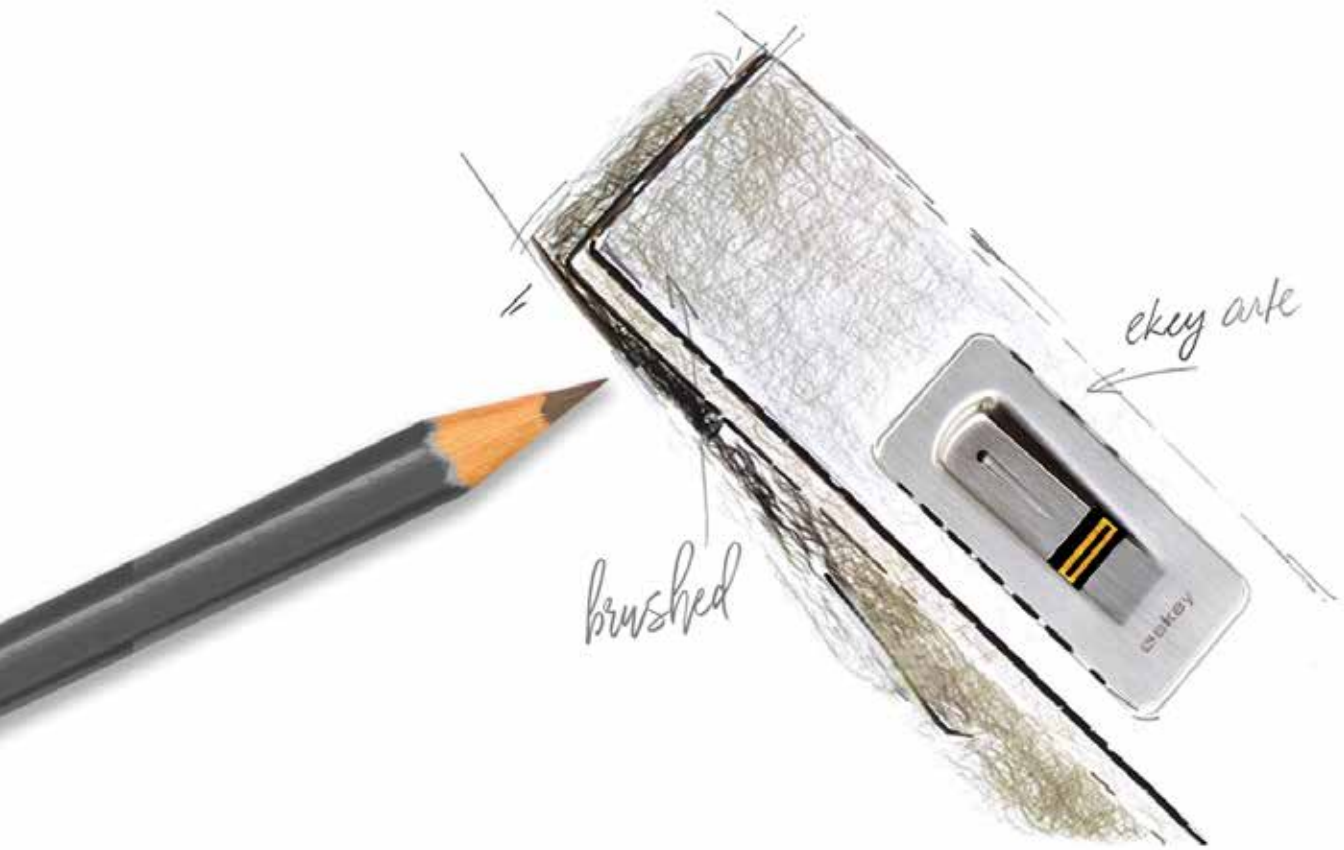

Made in Austria



ekey
Because innovation is paramount!

Europe's No. 1 for fingerprint access solutions

As a manufacturer and developer, ekey covers the whole spectrum.

More than one million satisfied customers are the best possible recommendation for our products! For many years, both private households and leading companies alike, along with organizations such as fire and rescue services, have been putting their trust in proven *ekey* finger scanners.



ekey was founded in 2002 and is now Europe's No. 1 for fingerprint access solutions. ekey puts authorization into the customer's hands! Keys, cards, codes, etc. can be lost, forgotten, or stolen. "Your finger is always on hand!" ekey's wide range of products includes finger scanners for doors, gates, alarm systems, and time recording.

The international company currently has over 90 employees at its 5 locations in Austria, Germany, Liechtenstein/Switzerland, Italy, and Slovenia, and exports its products to over 70 countries, which makes up 73% of its business. ekey's main sales markets include Spain and the USA, in addition to Austria, Germany, Switzerland, Slovenia, and Italy.

QUALITY

All ekey products undergo a rigorous endurance test before they reach the market. The test involves intensive simulations of blazing heat, biting cold, and high humidity; each finger scanner, along with all of its components, is subjected to these conditions countless times before reaching the customer.

Our formula for quality consists of the highest standards of functionality, reliability, and security, which are refined through extensive testing.

Quality-tested products from ekey – you can count on us!

CERTIFIED QUALITY MADE IN AUSTRIA:

- Extensive production, manufacturing, and functional testing (zero tolerance)
- Testing for environmental and temperature resistance
- Vibration and shock-tested
- Tested for penetration of water and mechanical parts
- Quality management system in accordance with EN ISO 9001:2015
- CE-compliant



arte

With its compact design, the *ekey arte* is ideal for flush installation in door leaves, door handles, and fittings.



integra

Due to its slim installation depth, the *finger scanner integra* is the ideal solution for integration in and next to doors.



integra keypad

The ekey code pad – an alternative to the finger scanner or the perfect complement.

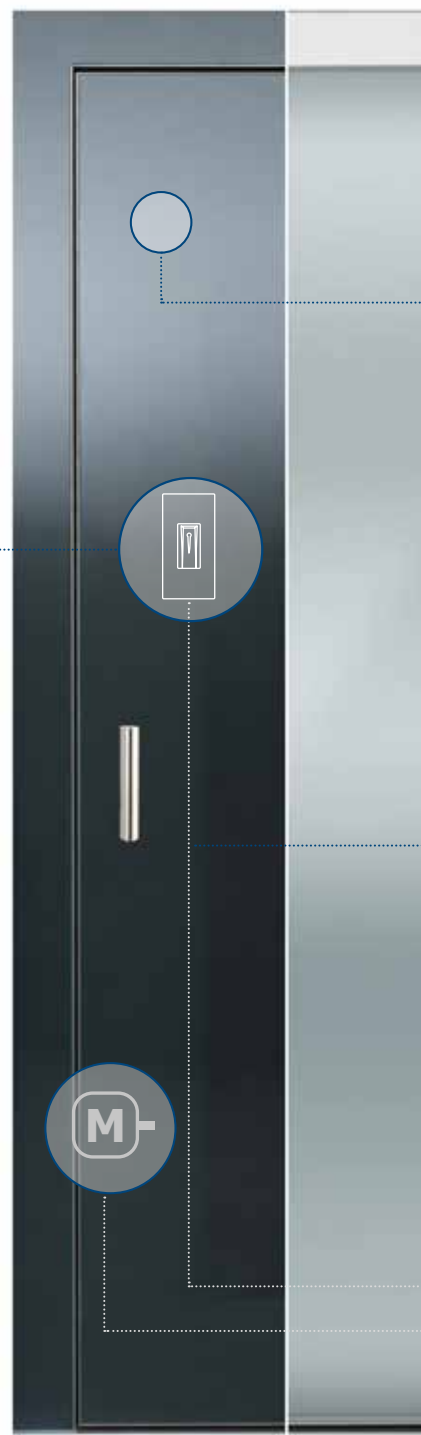

ekey home app

Intuitive operation makes administration incredibly easy. More information is available on page 19.

The *ekey home app* is only compatible with the finger scanners *arte* and *integra*.

So many possibilities
ekey solutions couldn't be easier to use.



VERSATILITY

Plastic, aluminum, or wood – ekey is the perfect match for all doors and materials.

EASY INSTALLATION

ekey finger scanner systems are designed to ensure quick and easy installation.

PLUG & PLAY SYSTEM

Plug-in wiring solution for all major lock manufacturers and cable transfers.

SIMPLE MAINTENANCE

Optimal positioning of the elements ensures easy accessibility.



- Unique identification
- Highly innovative technology
- Person-specific configuration
- Access control
- Energy saving
- Accessibility



App operation
video



Mounting
instructions

Finger scanner arte

Simple design for discreet integration

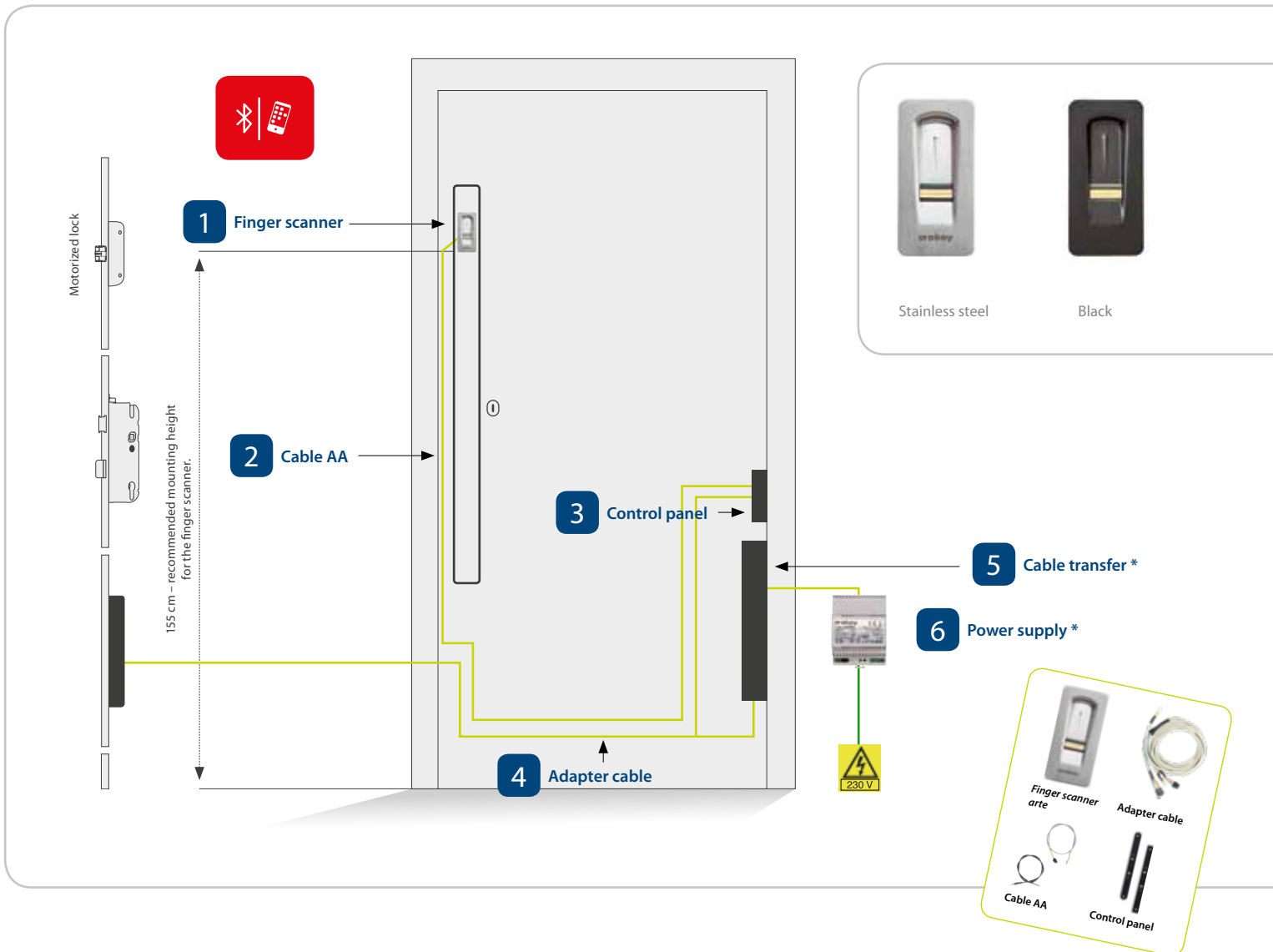

Part no.	Finger scanner set arte with app: Finger scanner (1), cable AA 4 m (2), control panel (3), adapter cable (4), and cable for power supply 5 m	
	Description	Additional information
105001	ekey home set AR micro plus 1 GU Automatic	for GU-SECURY Automatic
105002	ekey home set AR micro plus 1 KFV_A	for KFV Genius A and A-openers
105003	ekey home set AR micro plus 1 WH_EAV3	for Winkhaus blueMatic EAV3
105004	ekey home set AR micro plus 1 WH_BM	for Winkhaus blueMotion
105005	ekey home set AR micro plus 1 FUHR	for FUHR multitronic/autotronic
105006	ekey home set AR micro plus 1 ROTO C	for Roto Eneo C
105007	ekey home set AR micro plus 1 MACO	for MACO Z-TA Comfort
105008	ekey home set AR micro plus 1 SCHÜCO S	for Schüco SafeMatic

*Cable transfer (5), power supply (6), and door handle are not included in the set and must be ordered separately.

Notice:

Power supplies, cable transfers, etc. can be found in the Accessories section beginning on page 21.



App operation video



Mounting instructions



Admin video

Finger scanner integra

The sleek all-rounder

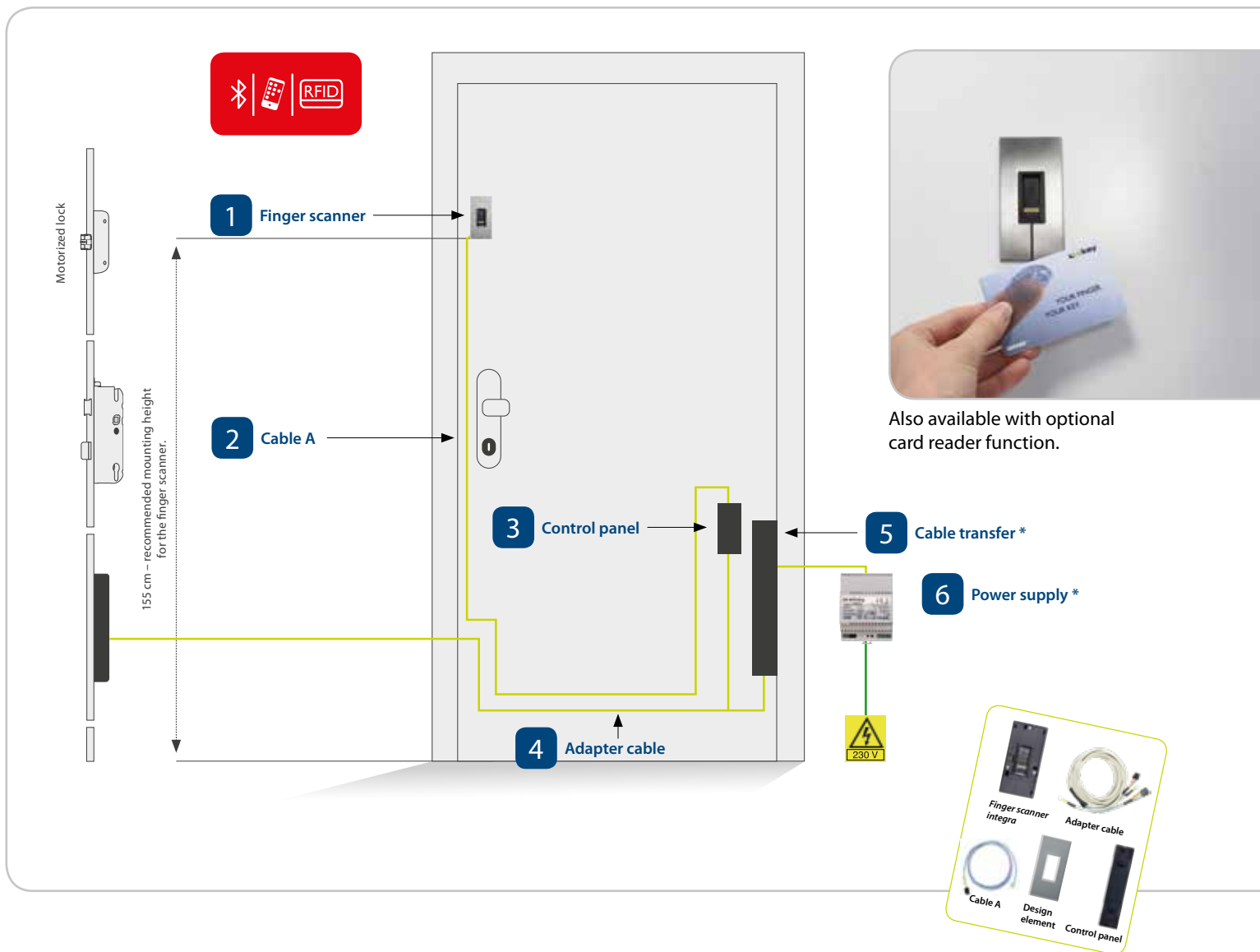

Also available with optional card reader function.

Part no.	Description	Additional information	with card reader function ** Part no.
	<i>Finger scanner set integra with app: Finger scanner and design element stainless steel gray (1), cable A 3.5 m (2), control panel (3), adapter cable (4), and cable 5 m for power supply</i>		
105101	ekey home set IN BT micro 1 GU Automatic	for GU-SECURY Automatic	105151
105102	ekey home set IN BT micro 1 KFV_A	for KFV Genius A and A-openers	105152
105103	ekey home set IN BT micro 1 WH_EAV3	for Winkhaus blueMatic EAV3	105153
105104	ekey home set IN BT micro 1 WH_BM	for Winkhaus blueMotion	105154
105105	ekey home set IN BT micro 1 FUHR	for FUHR multitronic/autotronic	105155
105106	ekey home set IN BT micro 1 ROTO C	for Roto Eneo C	105156
105107	ekey home set IN BT micro 1 MACO	for MACO Z-TA Comfort	105157
105108	ekey home set IN BT micro 1 SCHÜCO S	for Schüco SafeMatic	105158

*Cable transfer (5) and power supply (6) are not included in the set and must be ordered separately.

** Not available in all countries. Ask your sales partner.

Notice:

Power supplies, cable transfers, RFID cards, design elements, etc. can be found in the Accessories section beginning on page 21.



Mounting
instructions

keypad integra

The code pad – an addition to the finger scanner

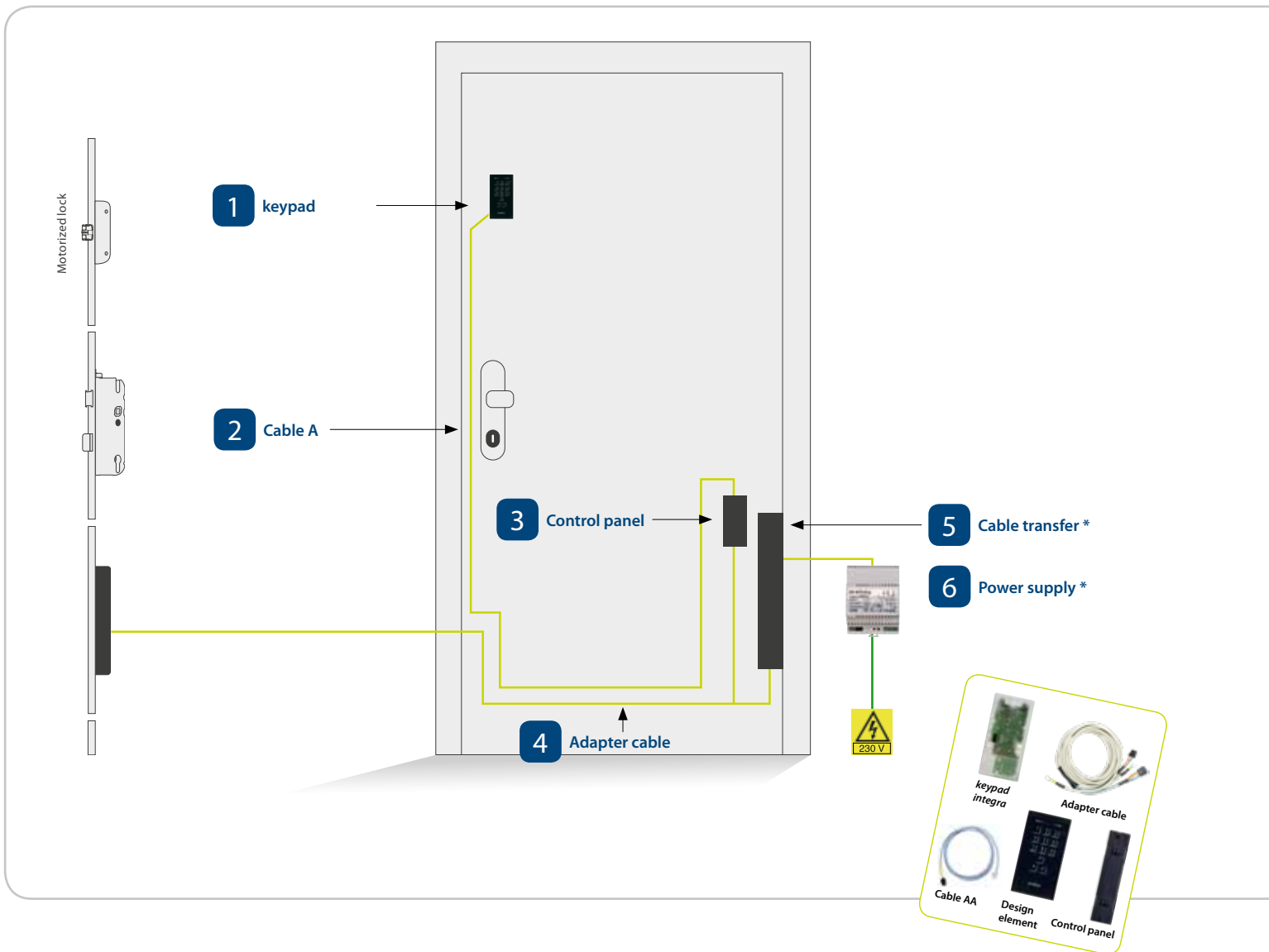

Part no.	keypad set integra: keypad and design element glass anthracite (1), cable A (2), control panel (3), adapter cable (4), and cable for power supply 5 m	
	Description	Additional information
105201	ekey home set KP micro 1 GL AN GU Automatic	for GU-SECURY Automatic
105202	ekey home set KP micro 1 GL AN KFV_A	for KFV Genius A and A-openers
105203	ekey home set KP micro 1 GL AN WH_EAV3	for Winkhaus blueMatic EAV3
105204	ekey home set KP micro 1 GL AN WH_BM	for Winkhaus blueMotion
105205	ekey home set KP micro 1 GL AN FUHR	for FUHR multitronic/autotronic
105206	ekey home set KP micro 1 GL AN ROTO C	for Roto Eneo C
105207	ekey home set KP micro 1 GL AN MACO	for MACO Z-TA Comfort
105208	ekey home set KP micro 1 GL AN SCHÜCO S	for Schüco SafeMatic

*Cable transfer (5) and power supply (6) are not included in the set and must be ordered separately.

! Notice:

Power supplies, cable transfers, design elements, etc. can be found in the Accessories section beginning on page 21.

ekey / smart home ready

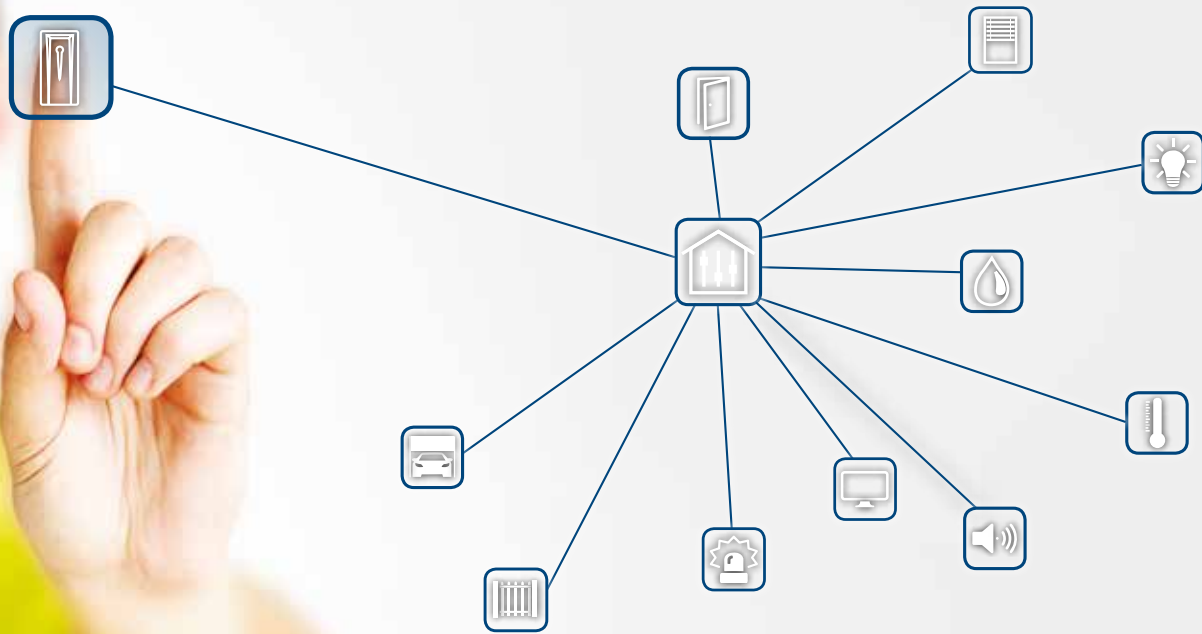

Make your house smart home ready and discover how easy everyday life can be.

It couldn't be simpler:

You can use the appropriate ekey interface (converter) to control a wide range of actions via your door.

- Operating the alarm system
- Controlling the audio system
- Customized scenarios
- Switching the light on/off
- Access control for individual doors
- ...and much more

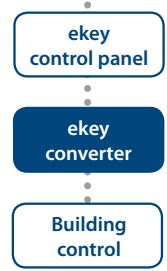
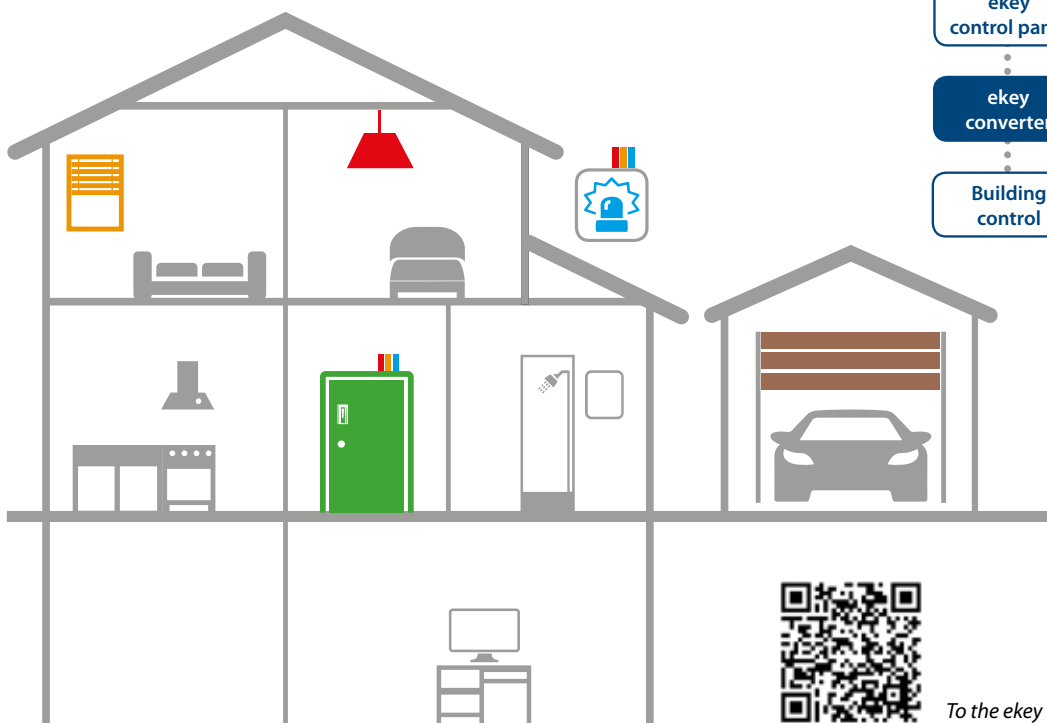

To the ekey website -> intelligent door

Integrating ekey finger scanners into building control systems

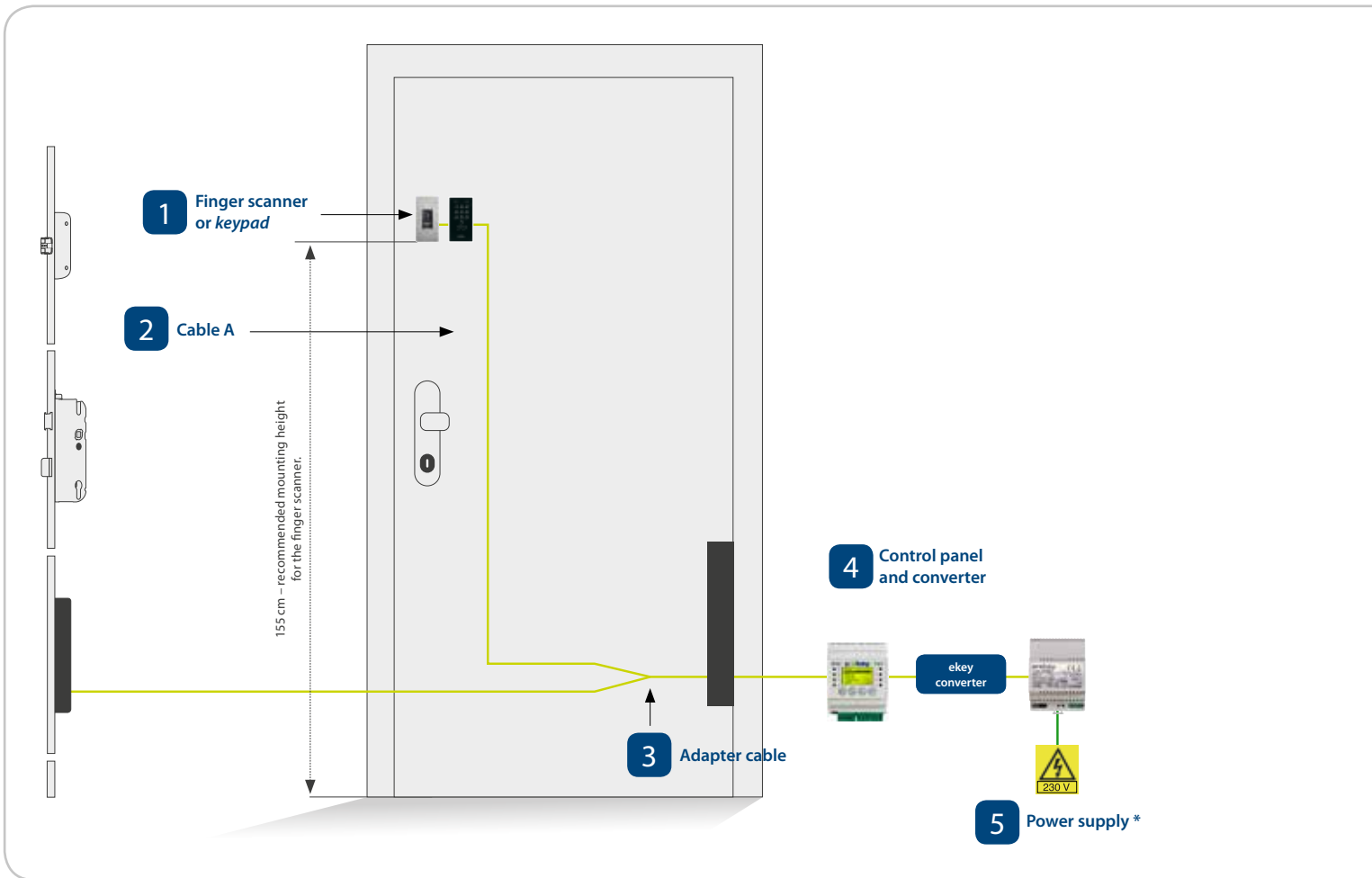

Part no.	Interface	Smart home set integra for all locks	
		Set contents: Finger scanner and design element stainless steel gray or keypad and design element glass anthracite (1), cable A 3.5 m (2), adapter cable (3), control panel and ekey converter (4) (if required), and cable 5 m for power supply	
		Description	Additional information
105191	KNX	ekey home set IN DRM 2 CV KNX	with home converter KNX
105192	LAN	ekey home set IN DRM 2 CV LAN	with home converter LAN RS-485
On request	FSX	ekey set FSX IN	
105291	KNX	ekey home set KP DRM 2 CV KNX	with home converter KNX
105292	LAN	ekey home set KP DRM 2 CV LAN	with home converter LAN RS-485

* Cable transfer and power supply (5) are not included in the set and must be ordered separately.

Notice:

Power supplies, cable transfers, RFID cards, design elements, etc. can be found in the Accessories section beginning on page 21.

KNX interfaces	LAN interfaces	FSX interfaces

The networkable door

The right solution for every requirement

ekey multi

Multi-point access solutions

4 finger scanners* are managed by a single control panel.

- Can store up to 99 fingerprints
- Supports up to 4 finger scanners
- Can control up to 4 functions per finger scanner (e.g., door, gate, and alarm system)
- Individually programmable time slots
- Access logging for every finger scanner
- Easy to operate with central user administration directly via the control panel
- User permissions can be assigned on a personalized basis (based on location and time)
- Vacation or permanent program
- Optional: Card access (RFID) is possible -> can also store up to 99 cards

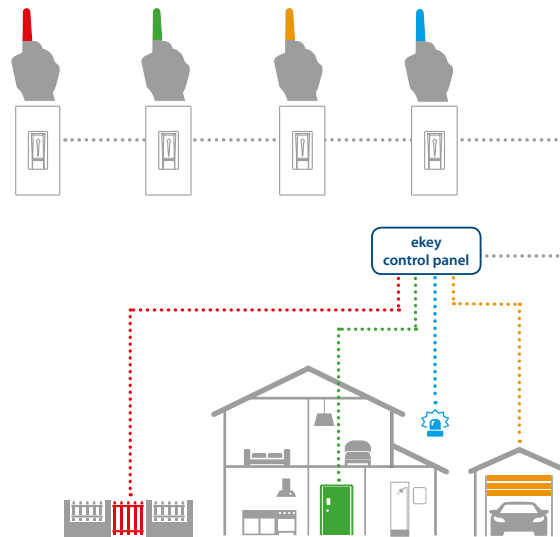

ekey net

Network access solutions

The networkable access solution for companies, organizations, and discerning households.

- Can store up to 2,000 fingerprints per finger scanner*
- Supports up to 80 finger scanners
- Can control up to 4 functions per finger scanner
- Programmable time slots
- Access logging for every finger scanner
- Supports cross-site administration
- Central administration via PC
- Calendar function
- Interfaces for establishing external connections
- Optional: Card access (RFID) is possible -> can also store up to 2,000 cards

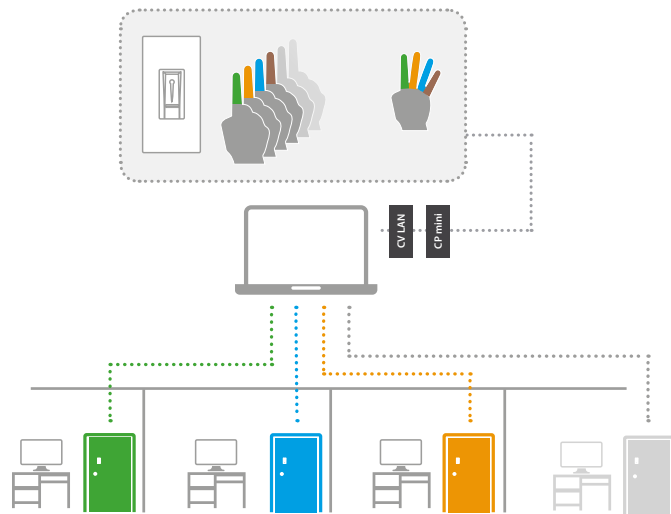

*Alternatively: Code pad (keypad) -> can store up to 99 or 2,000 codes



We would be delighted to help you plan and design your professional access control system. Simply contact us at [ekey.net/en/contact](mailto:info@ekey.net).



ekey net video

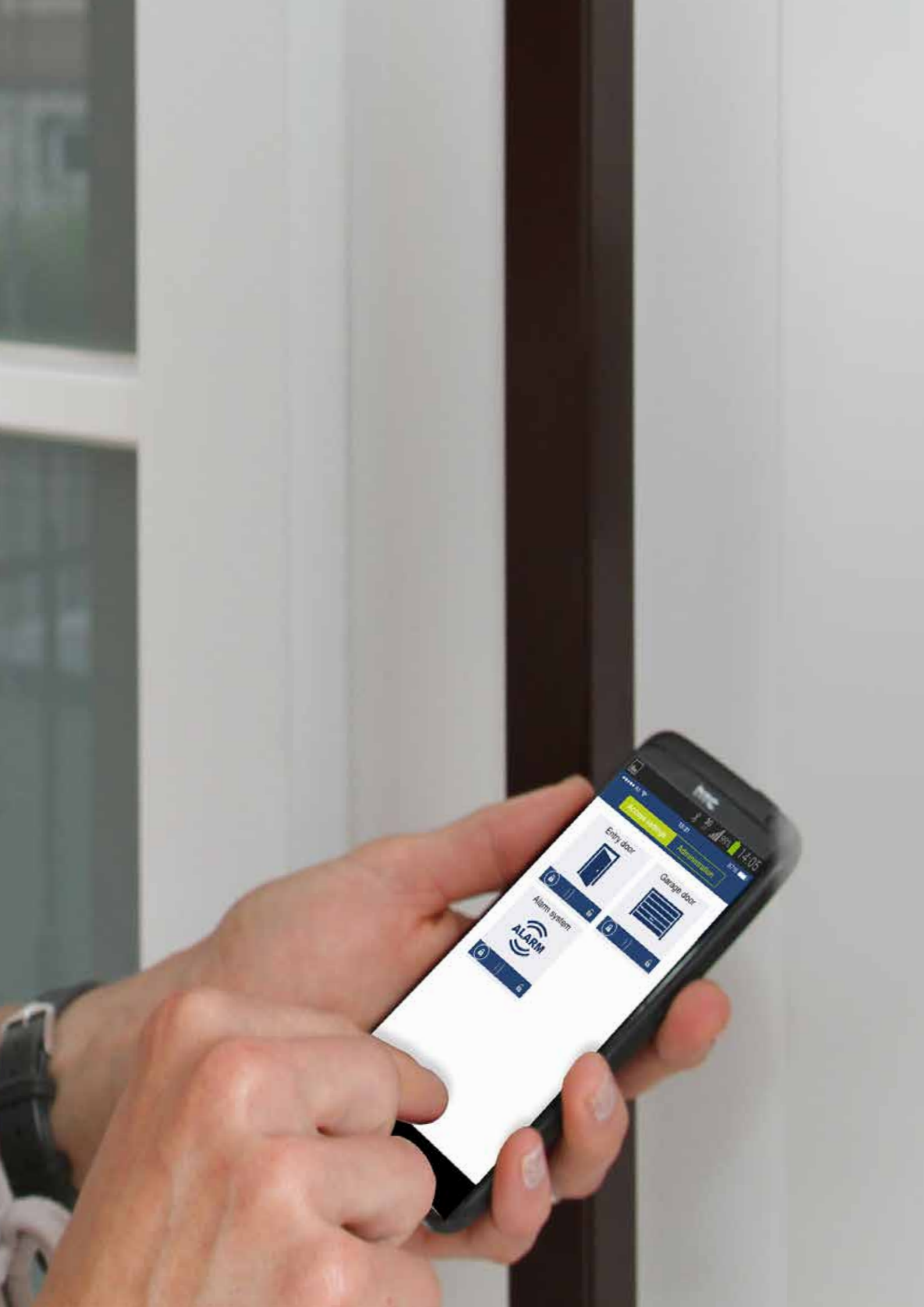

USER ADMINISTRATION

- Easy to create, manage, and delete users
- Enable or disable users at the touch of a button
- Assign authorizations for defined access
- Store fingers via the app
- Easy administration of up to 99 fingerprints
- Administration of up to 99 RFID cards*

ACCESS

- Open doors via app (smartphone/tablet)
- Assign access authorization with a user code
- Provide temporary access (while on vacation, for example)

SECURITY

- Administrator and user level
- 4 to 6-digit app security code
- Enhanced security thanks to 6-digit coupling code
- Administrator is able to change and administer security codes
- Deactivate the finger scanner's Bluetooth function

USEFUL TOOLS

- Adjustable LED brightness on the finger scanner
- Relay switching durations can be set individually
- Reset the system to default settings

The *ekey home app* is only compatible with the *ekey home – single-point access solutions* system!

* Only in the case of *ekey finger scanner integra Bluetooth RFID*



**ekey home app –
fool-proof menu navigation:**



FREE for ANDROID and iOS
Available languages:
DE | EN | IT | FR | ES | CS | PL | RU | ZH





YOUR STYLE. YOUR IDENTITY.



Perfectly coordinated – design + function



Part no.	Description
	Design element FS IN
101254	ekey design element FS IN SG, stainless steel gray
101305	ekey design element FS IN BL, black
101304	ekey design element FS IN WHI, white
101303	ekey design element FS IN GO, gold
	Design element FS IN RFID*
101688	ekey design element FS IN RFID SG, stainless steel gray
101904	ekey design element FS IN RFID BL, black
101933	ekey design element FS IN RFID WHI, white
	Design element FS IN (RFID) GL*
101978	ekey design element FS IN (RFID) GL SG, glass stainless steel gray
101980	ekey design element FS IN (RFID) GL AN, glass anthracite
101979	ekey design element FS IN (RFID) GL WHI, glass white



Part no.	Description
101677	ekey design element KP IN GL SG, glass stainless steel gray
101679	ekey design element KP IN GL AN, glass anthracite
101678	ekey design element KP IN GL WHI, glass white

* Not available in all countries. Ask your sales partner.

The whole color spectrum to choose from

And this is how it works:

- 1** Select a design element
- 2** Select the color

RAL Classic 213 color shades
- 3** Select the quantity

Minimum order quantity 10 units
- 4** Send request

office@ekey.net

Accessories



Part no.	Description
101909	ekey door handle mounting set FS arte, 16 mm



Part no.	Description
	ekey mounting plate CP micro (plus) Round faceplate
	ekey mounting plate CP micro (plus) Square-cut faceplate
101881	ekey mounting plate CP micro (plus), r20 mm
101882	ekey mounting plate CP micro (plus), r24 mm
101883	ekey mounting plate CP micro (plus), s20 mm
101884	ekey mounting plate CP micro (plus), s24 mm
	<ul style="list-style-type: none"> • Dimensions W x H x D: 20 (24) x 200 x 2.7 mm • ABS plastic, grained on the front side, black
	<ul style="list-style-type: none"> • Required mounting plate for the control panel micro plus in the door leaf

8-core cable transfer



Part no.	Description
100880	ekey CTL 48/8; cable transfer housing door leaf
	<ul style="list-style-type: none"> • Housing dimensions H x W x D: 478 x 24 x 17.5 mm • Housing installation in the door leaf • Door opening up to approx. 180° • Cable length on the frame side: 2.5 m
101475	ekey CTL 48/8; cable transfer housing door leaf
	<ul style="list-style-type: none"> • Housing dimensions H x W x D: 478 x 24 x 17.5 mm • Housing installation in the door leaf • Door opening up to approx. 180° • Cable length on the frame side: 10 m
100883	ekey CT without housing/8; cable transfer
	<ul style="list-style-type: none"> • Door opening up to approx. 180° • Cable length on the frame side: 2.5 m
100885	ekey CTL 30/8; cable transfer housing door leaf
	<ul style="list-style-type: none"> • Housing dimensions H x W x D: 300 x 24 x 17.5 mm • Housing installation in the door leaf • Door opening up to approx. 100° • Cable length on the frame side: 2.5 m
101967	ekey CTL 30/8; cable transfer housing door leaf
	<ul style="list-style-type: none"> • Housing dimensions H x W x D: 300 x 24 x 17.5 mm • Housing installation in the door leaf • Door opening up to approx. 100° • Cable length on the frame side: 10 m



The following specifications apply to all listed cable transfers:

- Cable: Li9Y11Y, 8 x 0.34 mm²
- Cable length on the leaf side: 0.8 m, with CP35/8 plug at the end for connecting to the control panel



Part no.	Description
100205	ekey PS DRM 230 VAC/12 VDC/2 A; DIN-rail-mounted
100891	ekey PS DRM 230 VAC/24 VDC/2 A; DIN-rail-mounted
100204	ekey PS OM 230 VAC/12 VDC/2 A; outlet-mounted
101742	ekey PS OM 230 VAC/24 VDC/1.1 A; outlet-mounted



Important: Select the power supply based on the properties of the motorized lock.

Uninterruptible power supply



Part no.	Description
101559	ekey UPS DRM 230 VAC/12 VDC/5 A + REBAT 4 Ah, DIN-rail-mounted
	<ul style="list-style-type: none"> • Dimensions W x H x D: UPS: 108 x 94 x 95 mm (6 HP) Battery: 157 x 93 x 66.5 mm (9 HP) • Supply voltage: 100-240 VAC • 2 parts: UPS (switched-mode power supply) and battery • Output voltage, output current: 12 VDC/5 A • Temperature range: -10 °C to 40 °C • Function display: LED • Advantage: Replaces line voltage power supply; ensures a reliable power supply to the system for several hours. Suitable for use in conjunction with a motorized lock.



Part no.	Description
101593	ekey UPS DRM 230 VAC/24 VDC/3 A + REBAT 4 Ah, DIN-rail-mounted
	<ul style="list-style-type: none"> • Dimensions W x H x D: UPS: 108 x 94 x 95 mm (6 HP) Battery: 157 x 93 x 66.5 mm (9 HP) • Supply voltage: 100-240 VAC • 3 parts: UPS (switched-mode power supply) and 2 x batteries • Output voltage, output current: 24 VDC/3 A • Temperature range: -10 °C to 40 °C • Function display: LED • Advantage: Replaces line voltage power supply; ensures a reliable power supply to the system for several hours. Suitable for use in conjunction with a motorized lock.



Important: Select the power supply based on the properties of the motorized lock.

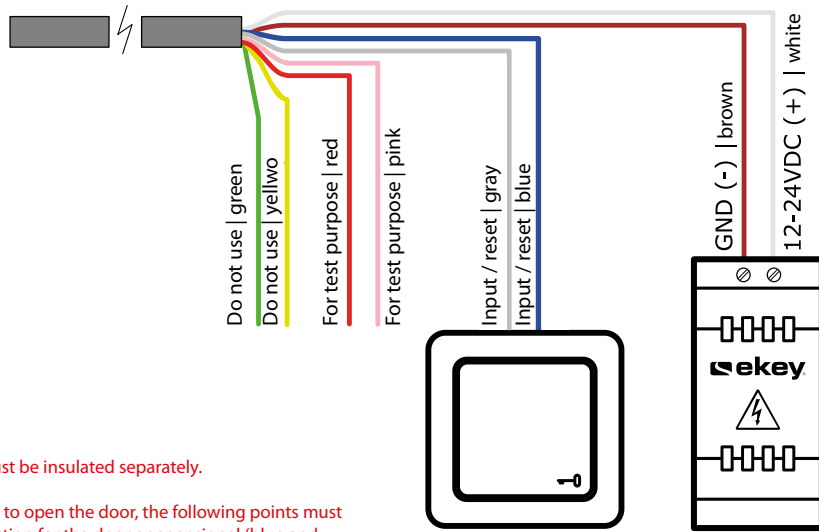

Each unused core must be insulated separately.



If an intercom is used to open the door, the following points must be noted: The connection for the door opener signal (blue and gray) should be established within the secured zone (inside the house) in order to prevent tampering. The electrician should use a suitable door station relay for this purpose.



ekey MEDIA CENTER

You can find all information on our products on our website at www.ekey.net/en/pro-mediacenter

Catalogs and folders

ekey downloads





Austria (headquarters)
ekey biometric systems GmbH
Lunzerstraße 89
A-4030 Linz
T: +43 732 890 500 - 0
E: office@ekey.net

Germany
ekey biometric systems Deutschland GmbH
Industriestraße 10
D-61118 Bad Vilbel
T: +49 6187 90696 - 0
E: office@ekey.net

Switzerland & Liechtenstein
ekey biometric systems Est.
Landstrasse 79
FL-9490 Vaduz
T: +41 71 560 5480
E: office@ekey.ch

Adriatic East region
ekey biometric systems d.o.o.
Vodovodna cesta 99
SI-1000 Ljubljana
T: +386 1 530 94 89
E: info@ekey.si

Italy
ekey biometric systems Srl.
Via Copernico 13/A
I-39100 Bolzano
T: +39 0471 922712
E: italia@ekey.net